

**Stud:**

Alloy steel, hardened, ground,  
 $d1 \geq 12$ : with grease hole, with eccentric collar

**Ring:**

Bearing steel, hardened, ground, polished,  
 with plastic axial plain washers on both sides

螺栓: 合金钢, 淬火, 磨加工,  $d1 \geq 12$  有油孔, 带有偏心套  
 外圈: 轴承钢, 淬火, 磨加工, 抛光, 两侧塑料推力滑动垫圈

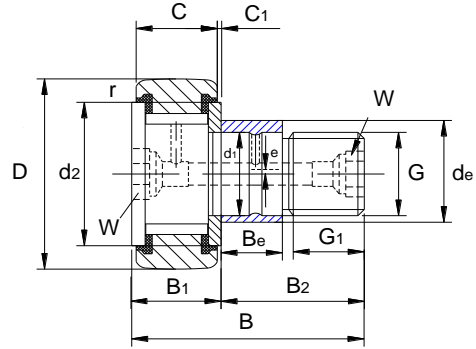

Bearing No.	Dimensions in millimeters															Properties					Weight
型号	尺寸 mm															性能					重量
	D	d1	B	B1	B2	Be	C	C1	d2	de	e	G	G1	r	W	MA	Crw	Corw	Curw	NDG	
		h7		max						h9		6g		min		Nm	KN	KN	KN	l/min	≈kg
KRE 16 PP	16	6	28	12.2	16	7	11	0.6	12.5	9	0.5	M6×1	8	0.15		3	3.15	3.3	0	14000	0.02
KRE 19 PP	19	8	32	12.2	20	9	11	0.6	15	11	0.5	M8×1	10	0.15		8	3.5	3.9	0	11000	0.032
KRE 22 PP	22	10	36	13.2	23	10	12	0.6	17.5	13	0.5	M10×1	12	0.3	5	15	4.5	5.2	1	8000	0.047
KRE 26 PP	26	10	36	13.2	23	10	12	0.6	17.5	13	0.5	M10×1	12	0.3	5	15	5.1	6.2	1	8000	0.062
KRE 30 PP	30	12	40	15.2	25	11	14	0.6	23	15	0.5	M12×1	13	0.6	6	22	6.8	8.4	1	5500	0.093
KRE 32 PP	32	12	40	15.2	25	11	14	0.6	23	15	0.5	M12×1.5	13	0.6	6	22	7.1	8.9	1	5500	0.104
KRE 35 PP	35	16	52	19.6	32.5	14	18	0.8	27.6	20	1	M16×1.5	17	0.6	8	58	9.7	14.1	2	3600	0.177
KRE 40 PP	40	18	58	21.6	36.5	16	20	0.8	31.5	22	1	M18×1.5	19	1	8	87	10.9	15.8	3	2900	0.255
KRE 47 PP	47	20	66	25.6	40.5	18	24	0.8	36.5	24	1	M20×1.5	21	1	10	120	15.4	26	3	2400	0.4
KRE 52 PP	52	20	66	25.6	40.5	18	24	0.8	36.5	24	1	M20×1.5	21	1	10	120	16.6	29	4	2400	0.473
KRE 62 PP	62	24	80	30.6	49.5	22	29	0.8	44	28	1	M24×1.5	25	1	14	220	26	48	7	1900	0.798
KRE 72 PP	72	24	80	30.6	49.5	22	29	0.8	44	28	1	M24×1.5	25	1.1	14	220	28	53	7	1900	1.038
KRE 80 PP	80	30	100	37	63	29	35	1	53	35	1.5	M30×1.5	32	1.1	14	450	38.5	77	11	1300	1.665
KRE 90 PP	90	30	100	37	63	29	35	1	53	35	1.5	M30×1.5	32	1.1	14	450	40.5	83	12	1300	2.032

- W: Nominal dimension for hexagonal socket
- MA: Nut tightening torque
- Crw: Effective dynamic load rating as track roller (radial)
- Corw: Effective static load rating as track roller (radial)
- Curw: Fatigue limit load
- NDG: Speed (for continuous operation and grease lubrication)

