

Outer rings:

Bearing steel, hardened, ground, polished,
gap seals on both sides

Inner rings:

Bearing steel, hardened, ground, polished

外圈：轴承钢，淬火，磨加工，抛光，两侧间隙密封

内圈：轴承钢，淬火，磨加工，抛光

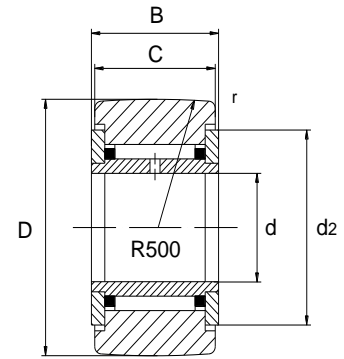

Bearing No. 型号	Dimensions in millimeters 尺寸 mm						Properties 性能				Weight 重量
	d	D	B	C	d2	r	Crw	Corw	Curw	NDG	
						min	KN	KN	KN	1/min	≈kg
NATR 5	5	16	12	11	12.5	0.15	3.15	3.3	0.415	14,000	0.014
NATR 6	6	19	12	11	15	0.15	3.5	3.9	0.485	11,000	0.02
NATR 8	8	24	15	14	19	0.3	5.5	6.4	0.81	7,500	0.41
NATR 10	10	30	15	14	23	0.6	6.8	8.4	1.07	5,500	0.064
NATR 12	12	32	15	14	25	0.6	6.9	8.8	1.27	4,500	0.071
NATR 15	15	35	19	18	27.6	0.6	9.8	14.1	1.7	3,600	0.104
NATR 17	17	40	21	20	31.5	1	10.9	15.5	1.85	2,900	0.144
NATR 20	20	47	25	24	36.5	1	15.5	25.5	3	2,400	0.246
NATR 25	25	52	25	24	41.5	1	15.4	26.5	3.5	1,800	0.275
NATR 30	30	62	29	28	51	1	23.4	38.5	4.65	1300	0.47

Crw: Effective dynamic load rating as track roller (radial)

Corw: Effective static load rating as track roller (radial)

Curw: Fatigue limit load

NDG: Speed (for continuous operation and grease lubrication)